

QUINNIPAC 5k Hamden, CT



Certified CT040 PH

MEASURED POINTS

START: Even with large tree on the grass island between main driveway and East parking lot, even with the 14th parking space away from the building (in first double row). Runners must go around last space in the row closest to Mt. Carmel Ave., turn right and exit lot via auxiliary entrance near Hogan Rd.
 1 Mi - even w/ UI #5636, New Rd.
 2.5km - 30 past lightpole 6048 first pole on left, past main entrance gate.
 2 Mi - 75 ft. before Hogan Rd. entrance to school.
 3 Mi - 20 ft. past inside edge main entrance gate.
FINISH: Even with far edge of sidewalk, in front of athletic bldg. entrance

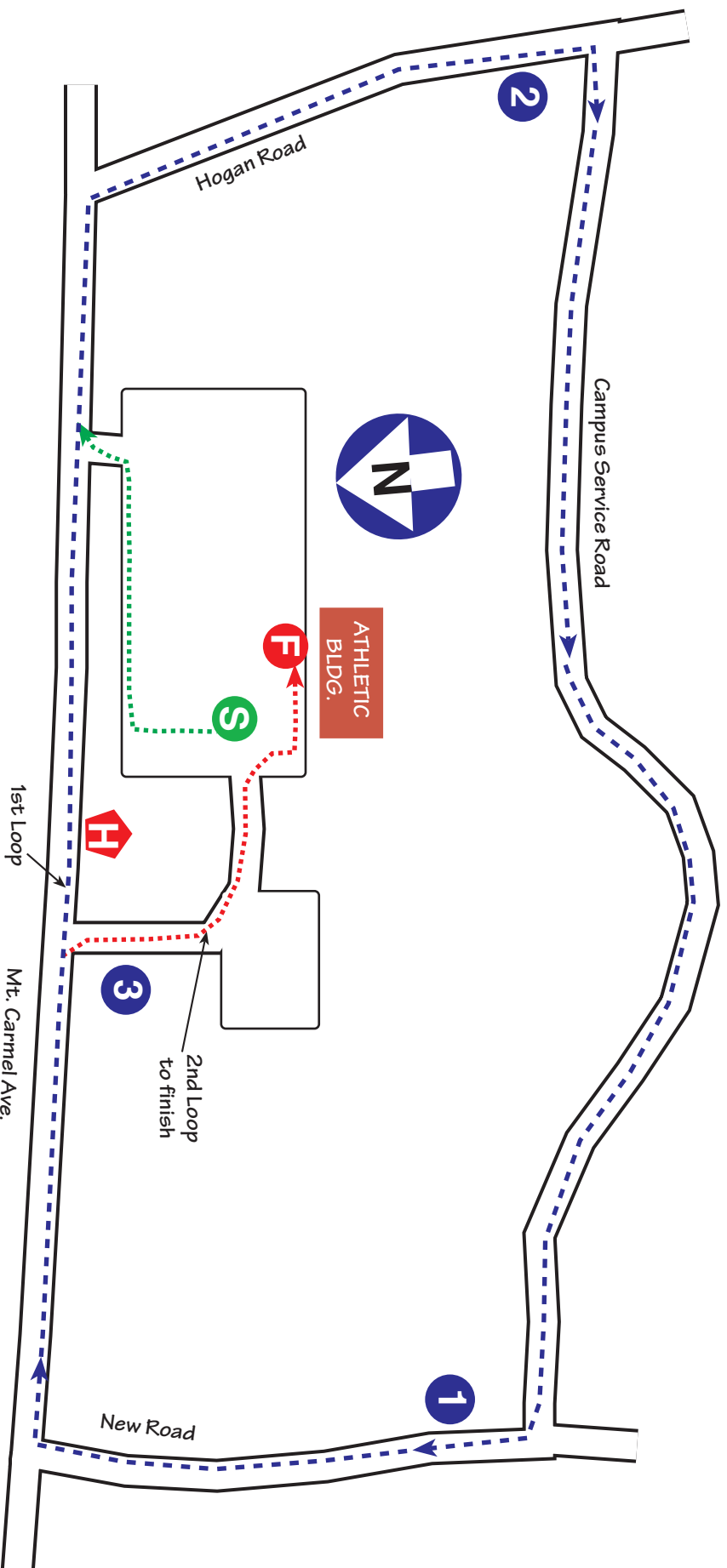

Measured by Jim Gerweck,
31 October 2003